

# TECHNICAL SPECIFICATIONS

# RAM V3T

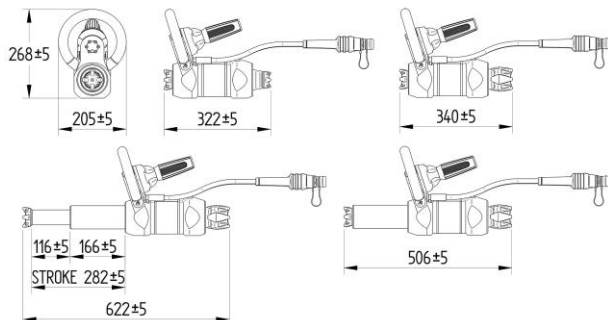

## RAM V3T

NEO1 

HP/FF 

Nominal pressure	UltimatePressure™ 350 bar	UltimatePressure™ 350 bar
Tailhose safety factor	8:1 (2,800 bar)	8:1 (2,800 bar)
Dimensions incl. add. detachable rear jaw (L x W x H)	340 x 205 x 268 mm	340 x 205 x 268 mm
Dimensions excl. add. detachable rear jaw (L x W x H)	322 x 205 x 268 mm	322 x 205 x 268 mm
Max. extended length incl. add. detachable rear jaw	622 mm	622 mm
Max. Stroke (hydraulic stroke + added jaw)	282 + 18 mm	282 + 18 mm
Operational weight	12.4 kg (±0.2 kg)	12.5 kg (±0.2 kg)
Operational weight incl. add. detachable rear jaw	13.1 kg (±0.2 kg)	13.2 kg (±0.2 kg)
Max. spreading / pushing force (first stage)	203 kN / 20.7 ton	203 kN / 20.7 ton
Max. spreading / pushing force (second stage)	91 kN / 9.3 ton	91 kN / 9.3 ton
EN 13204	TR 203/166-91/116-12.4	TR 203/166-91/116-12.5
NFPA 1936	Compliant	Compliant

## ACCESSORIES

ART. NR.

## ACCESSORIES

ART. NR.

LED light add-on	9500.1000	EX-150	8410.0500.20
Ram support	2350.0535	EX-300	8410.0510.20
Crown	8420.0000		
Rhino	8420.0020		
Multiswivel	8420.3550		
Fixed base	8420.0300		



**PRESSURE™**  
**ULTIMATE**



**RESQTEC Zumro B.V.**  
 Meer en Duin 82 | 2163 HC Lisse, the Netherlands

**T** +31 (0)252 419002 **F** +31 (0)252 411794  
**E** info@resqtec.com **W** www.resqtec.com

**RESQTEC®**